

DeltaPSU Product Notice



CLiQ M DC-UPS Modules Product Change Notice

Please be informed that the buffer time for CLiQ M DC-UPS modules will be revised from “2 min” to “30 min”.

For detailed information, please refer to the table below.

Implementation Date: Jan-2023

Model List:

Models	Revision
DRU-24V10AMN	02
DRU-24V20AMN	02
DRU-24V40AMN	02

Change Details:

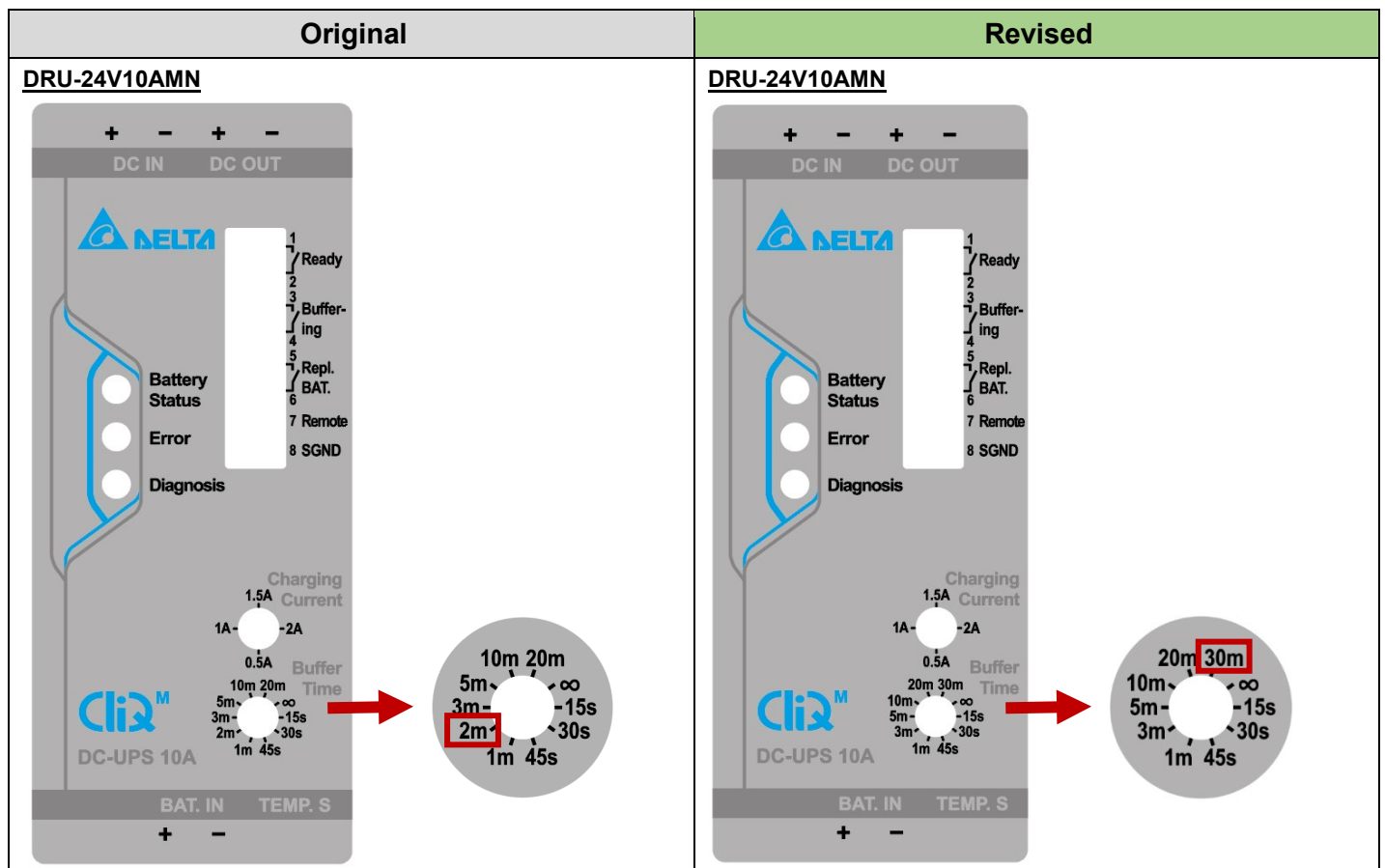

DeltaPSU Product Notice

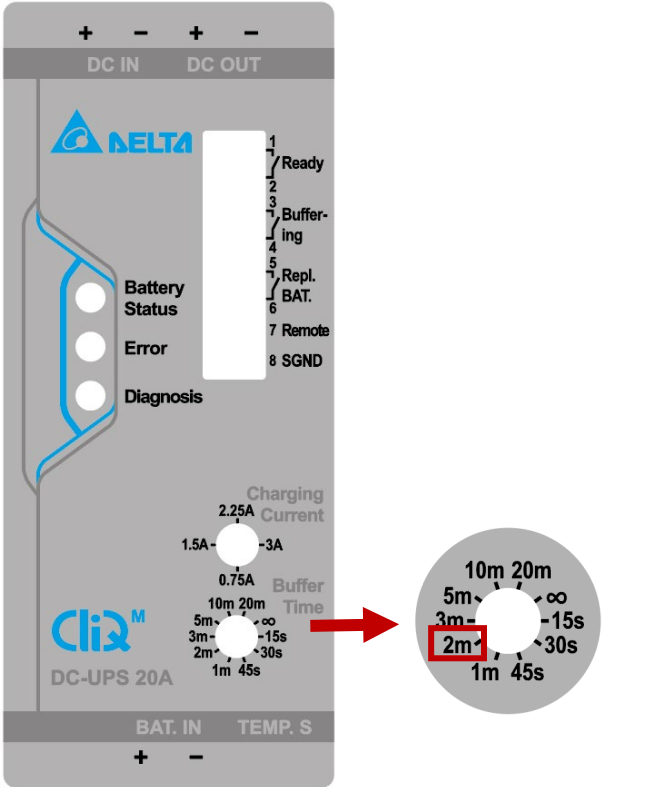
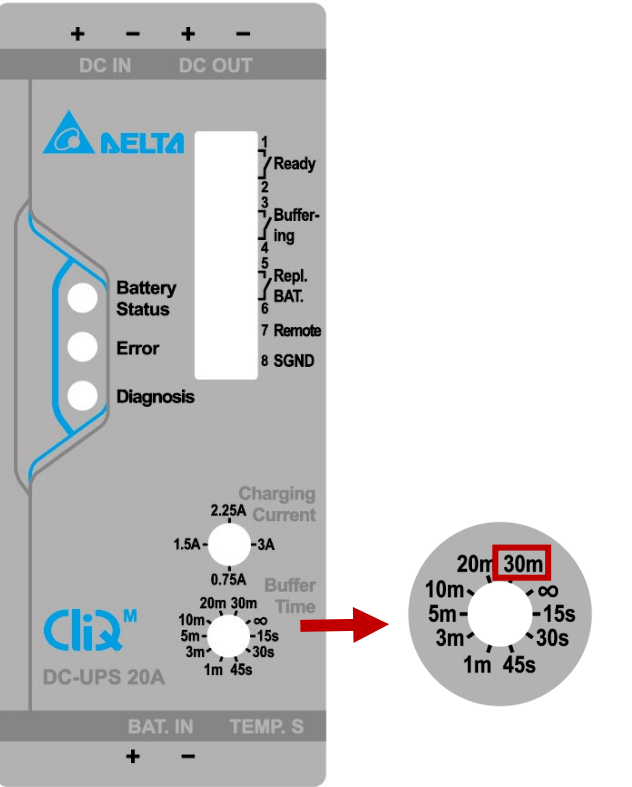
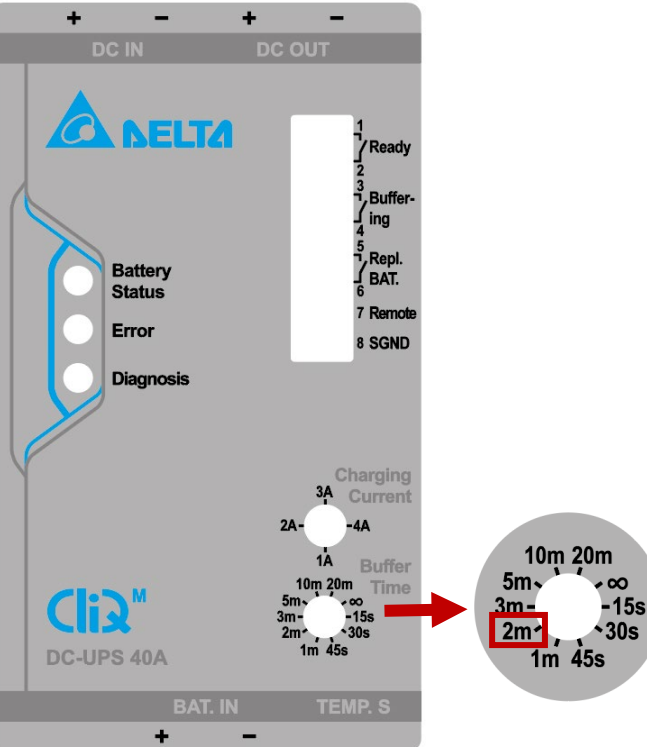
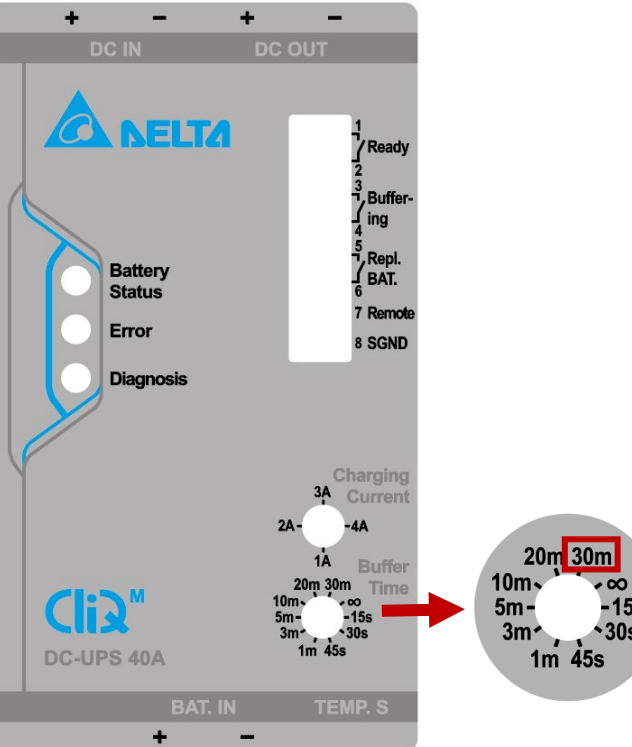

Original	Revised
<p>DRU-24V20AMN</p>  <p>The image shows the original control panel for the DRU-24V20AMN model. It features a 'Buffer Time' knob with settings: 10m, 20m, 5m, 3m, 2m, 1m, ∞, 15s, 30s, and 45s. The '2m' setting is highlighted with a red box. A red arrow points from the knob to the highlighted '2m' value.</p>	<p>DRU-24V20AMN</p>  <p>The image shows the revised control panel for the DRU-24V20AMN model. The 'Buffer Time' knob settings are: 20m, 30m, 10m, 5m, 3m, 1m, ∞, 15s, 30s, and 45s. The '30m' setting is highlighted with a red box. A red arrow points from the knob to the highlighted '30m' value.</p>
<p>DRU-24V40AMN</p>  <p>The image shows the original control panel for the DRU-24V40AMN model. It features a 'Buffer Time' knob with settings: 10m, 20m, 5m, 3m, 2m, 1m, ∞, 15s, 30s, and 45s. The '2m' setting is highlighted with a red box. A red arrow points from the knob to the highlighted '2m' value.</p>	<p>DRU-24V40AMN</p>  <p>The image shows the revised control panel for the DRU-24V40AMN model. The 'Buffer Time' knob settings are: 20m, 30m, 10m, 5m, 3m, 1m, ∞, 15s, 30s, and 45s. The '30m' setting is highlighted with a red box. A red arrow points from the knob to the highlighted '30m' value.</p>